

Zubehör Mod. Puffer B

Puffer Typ B

Articolo Article Artikel	Dimension		Compression				Shear			
	D x H (mm)	G x L (mm)	Load (daN)	C = daN/cm			Load (daN)	C = daN/cm		
				h	m	w		h	m	w
B 10x8	10x8	M4x10	5	64	44	22	1,5	14,8	10,2	5,7
B 16x15	16x15	M4x10	10	106	66	30	3	19,2	13,3	7,4
B 20x20	20x20	M6x18	15	121	83	50	6	24	16	9,3
B 20x25	20x25	M6x18	15	84	58	36	6	18	13	7,1
B 25x20	25x20	M6x18	25	195	138	86	10	40	27	14
B 30x25	30x25	M8x20	35	202	136	89	15	45	30	16
B 30x30	30x30	M8x20	35	155	107	65	15	35	24	13
B 40x30	40x30	M8x23	60	303	192	130	25	63	43	24
B 40x40	40x40	M8x23	60	195	136	83	25	45	31	17
B 50x20	50x20	M10x25	100	1587	1000	540	40	160	110	61
B 50x30	50x30	M10x25	100	571	395	219	40	98	68	37
B 50x40	50x40	M10x25	100	369	260	147	40	71	49	27
B 75x50	75x50	M12x37	220	733	507	281	90	129	90	50
B 75x55	75x55	M12x37	220	637	438	243	90	117	81	45
B100x40	100x40	M16x44	400	2877	1951	982	150	319	221	122
F = G										

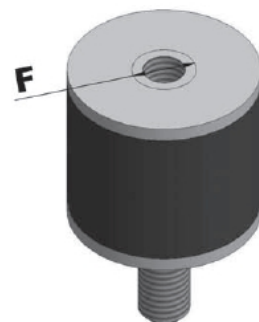

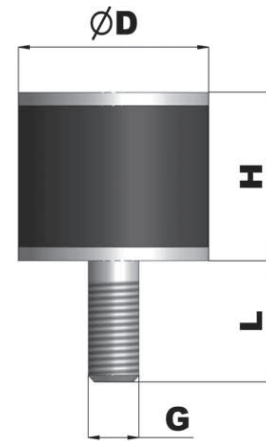

Technische Spezifikationen

Puffer tipo B

Articolo	Dimensioni (mm)			Compression			
	DxH	GxL	F	Load daN	C=daN/cm h m w		
B 10x8	10x8	M 4x10	M4	5,0	64	44	22
B 16x15	16x15	M 4x10	M4	10,0	106	66	30
B 20x20	20x20	M 6x18	M6	15,0	121	83	50
B 20x25	20x25	M 6x18	M6	15,0	84	58	36
B 25x20	25x20	M 6x18	M6	25,0	195	138	86
B 30x25	30x25	M 8x20	M8	35,0	202	136	89
B 30x30	30x30	M 8x20	M8	35,0	155	107	65
B 40x30	40x30	M 8x23	M8	60,0	303	192	130
B 40x40	40x40	M 8x23	M8	60,0	195	136	83
B 50x20	50x20	M10x25	M8	100,0	1587	1000	540
B 50x30	50x30	M10x25	M10	100,0	571	395	219
B 50x40	50x40	M10x25	M10	100,0	369	260	147
B 75x50	75x50	M12x37	M12	220,0	733	507	281
B 75x55	75x55	M12x37	M12	220,0	634	438	243
B 100x40	100x40	M16x44	M16	400,0	2877	1951	982